

ID	QTY.	DESC.
A	1	0.125 x 5 x 5
B	1	0.125 x 4 x 5
C	1	0.125 x 2 Dia.
D	1	0.125 x 5 x 5 Gusset
E	1	0.125 x 4 x 7

ALL PROCESSES TO BE COMPLETED WITH THE MATERIALS PROVIDED

1. TACK COMPLETE ASSEMBLY IN ANY POSITION.
2. WELDING TO BE COMPLETED WITH PLATE A FLAT TO THE TABLE
3. ALL VERTICAL WELDS TO BE WELDED IN THE UPHILL PROGRESSION.
4. NO POST WELD CLEANING ALLOWED

TITLE: STATE



Welding Contest

DWG. NO.

GTAW - Aluminum

THE INFORMATION CONTAINED IN THIS DRAWING IS THE SOLE PROPERTY OF WELDERMADE.COM. ANY REPRODUCTION IN PART OR AS A WHOLE WITHOUT THE WRITTEN PERMISSION OF WELDERMADE.COM IS PROHIBITED.

STATE SUSAT

SHEET 1 OF 1

PART	DESCRIPTION	QTY.
A	7" x 6" x .25	1
B	6" x 6" x .25	1
C	5" x 4" x .25	1
D	7" x 5.75" x .25	1
E	2.5" circle .25	1
F	3.75" x 5.75" x .25	1

ALL PROCESSES TO BE COMPLETED WITH THE MATERIALS PROVIDED ALL WELD PROCESSES/PROCEDURES ASSIGNED BY TECHNICAL COMMITTEE

1. TACK AND COMPLETE ASSEMBLY IN ANY POSITION.
2. WELDING TO BE COMPLETED WITH PLATE A FLAT TO THE TABLE
3. ALL VERTICAL WELDS TO BE WELDED IN THE UPHILL PROGRESSION.
4. Weld #7 WELD COMPLETE ASSEMBLY B&C

TITLE: STATE



WELDING CONTEST

DWG. NO. SMAW, GMAW, FCAW-G

welder-made.com SHEET 1 OF 1

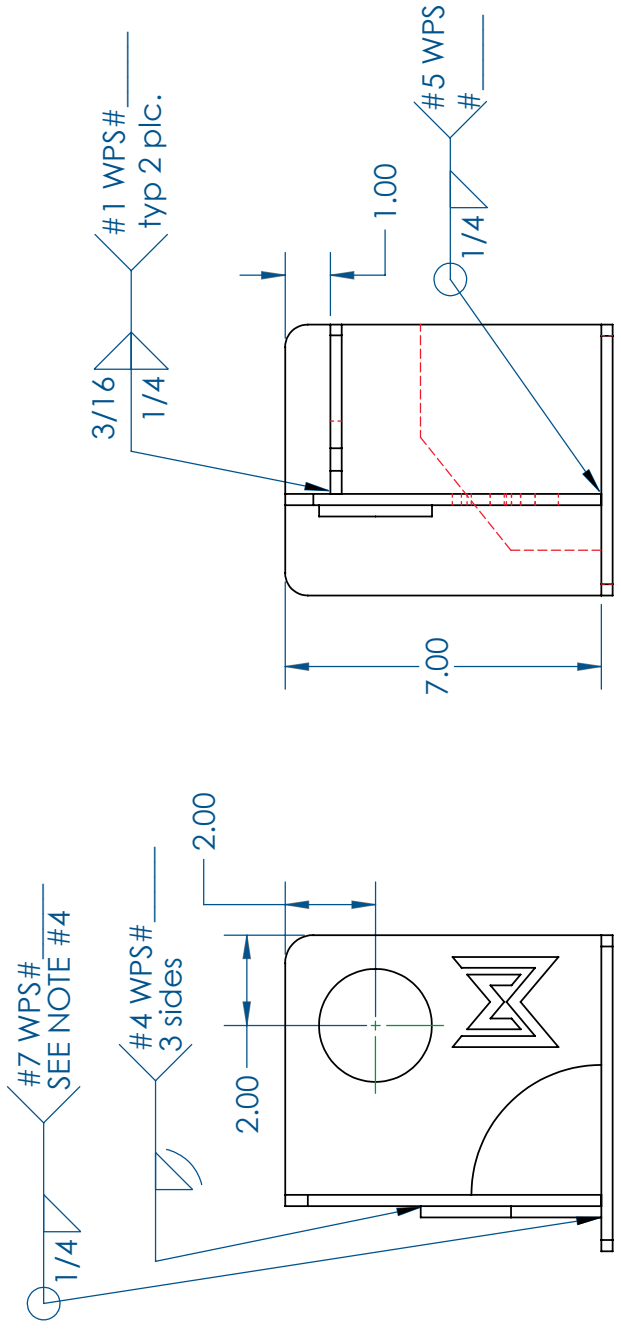
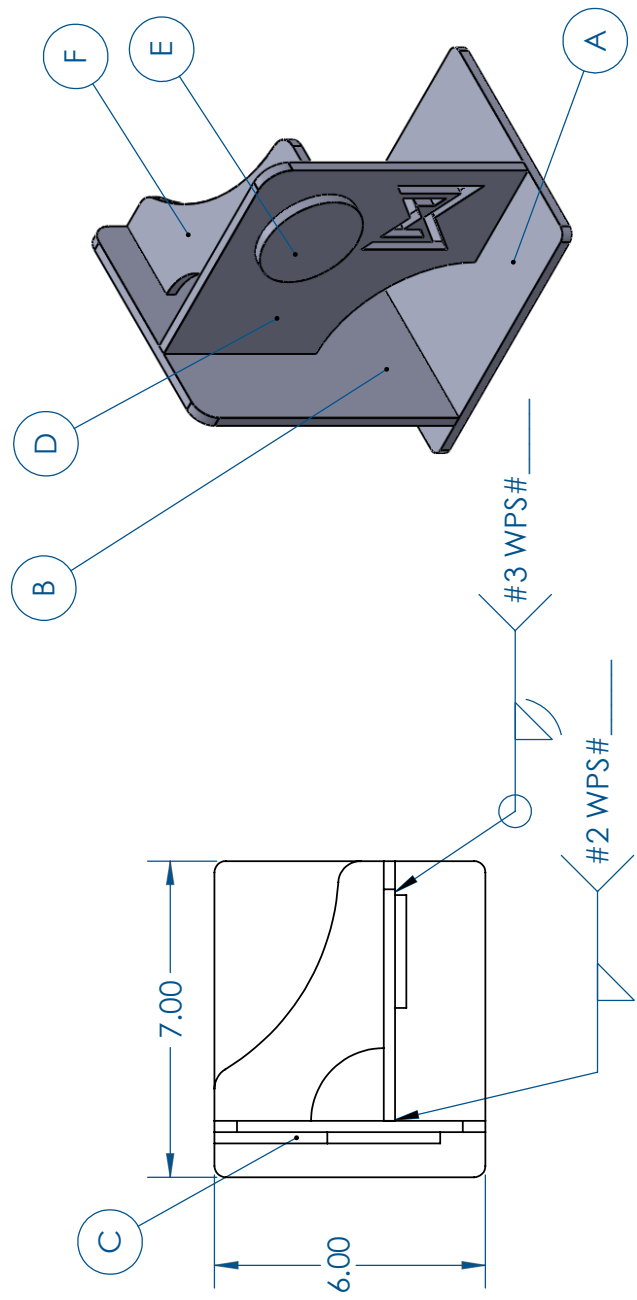

THE INFORMATION CONTAINED IN THIS DRAWING IS THE SOLE PROPERTY OF WELDERMADE.COM. ANY REPRODUCTION IN PART OR AS A WHOLE WITHOUT THE WRITTEN PERMISSION OF WELDERMADE.COM IS PROHIBITED.

Item	Qty.	Description
A	1	0.25 x 6 x 6.5

ALL PROCESSES TO BE COMPLETED WITH THE MATERIALS PROVIDED

NOTE: PERFORM A SQUARE CUT ALONG DASHED LINE

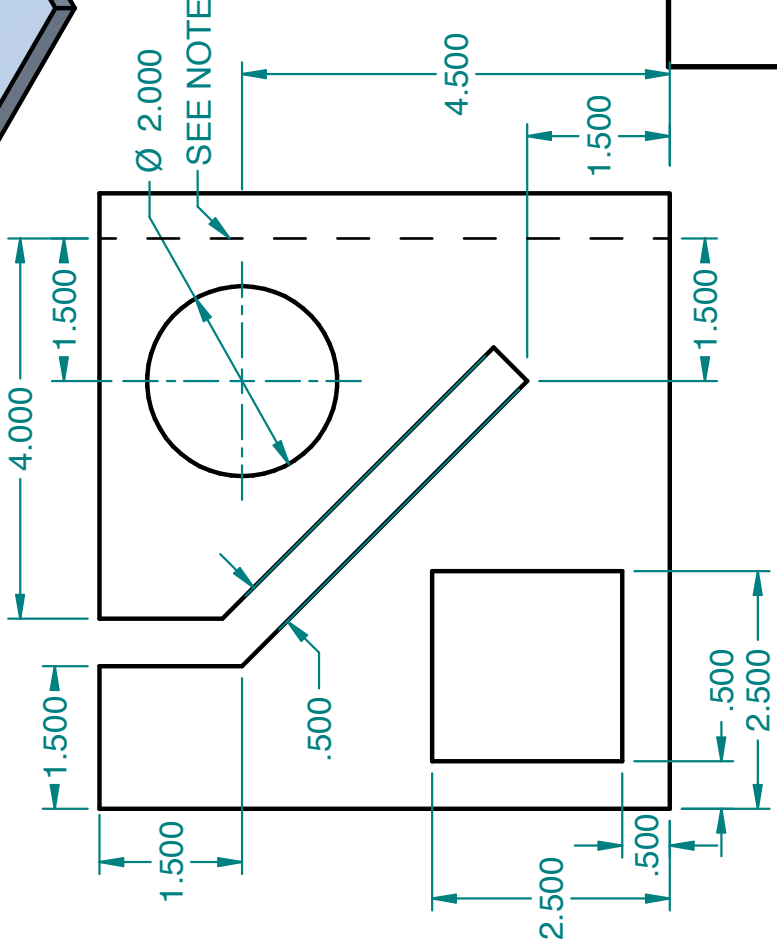
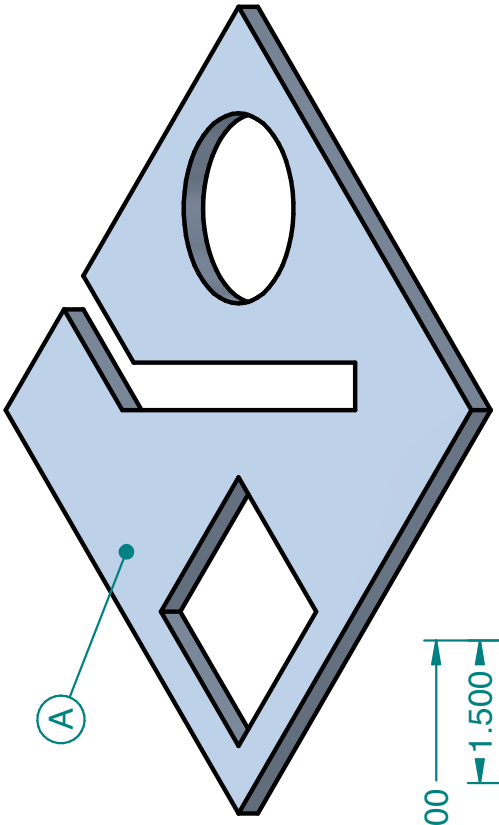

SkillsUSA
Welding Contest

TITLE
PAC or OFC

SIZE
A

UNLESS OTHERWISE SPECIFIED DIMENSIONS ARE IN INCHES

